

# CITY OF ALBUQUERQUE NEW MEXICO

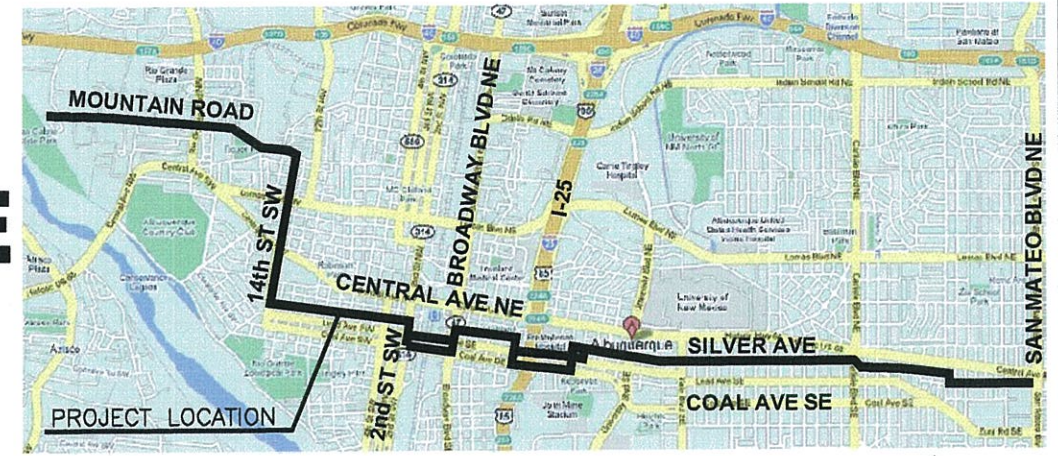

VICINITY MAP  
NTS  
ZONE ATLAS MAPS  
J-12 TO J-14  
K-13 TO K-17



## CONSTRUCTION PLANS FOR BICYCLE BOULEVARD COA PROJECT NO. 7986.91

**PHASE I: Silver Ave from San Mateo to Cedar Street**  
**PHASE II: Silver Ave from 14th St to Second St**  
**PHASE III: Silver Ave from Cedar Street to Second Street**

### INDEX OF SHEETS

1	COVER SHEET
2	GENERAL NOTES
3	SUMMARY OF QUANTITIES
4-18	SIGNING AND STRIPING PLANS
19-20	SIGN FACE DETAILS
21	PAVEMENT MARKING DETAILS, PAVEMENT MARKING AND PERMANENT SIGNING NOTES
22	SILVER-GIRARD INTERSECTION IMPROVEMENT PLAN

**Gannett Fleming West, Inc.**

2155 Louisiana NE, Suite 7000 Albuquerque, New Mexico 87110  
Office: (505) 265-8468 Facsimile: (505) 881-2513

REV.	SHEETS	CITY ENGINEER	DATE	USER DEPARTMENT	DATE	USER DEPARTMENT	DATE
ENGINEERS STAMP & SIGNATURE		APPROVALS	ENGINEER	DATE	*****		
		DRC Chairman			APPROVED FOR CONSTRUCTION		
		Transportation					
		Water/Wastewater					
		Hydrology					
		Parks					
		Constr. Mngmt.			City Engineer	Date	
		Constr. Coord.					
		City Project No.			Sheet	Of	
		7986.91			1	22	







Mountain Rd - Montoya to Rio Grande Blvd  
 Project: 7986-91  
 City of Albuquerque, NM  
 Date: 11/27/2008  
 Author: M. J. M.

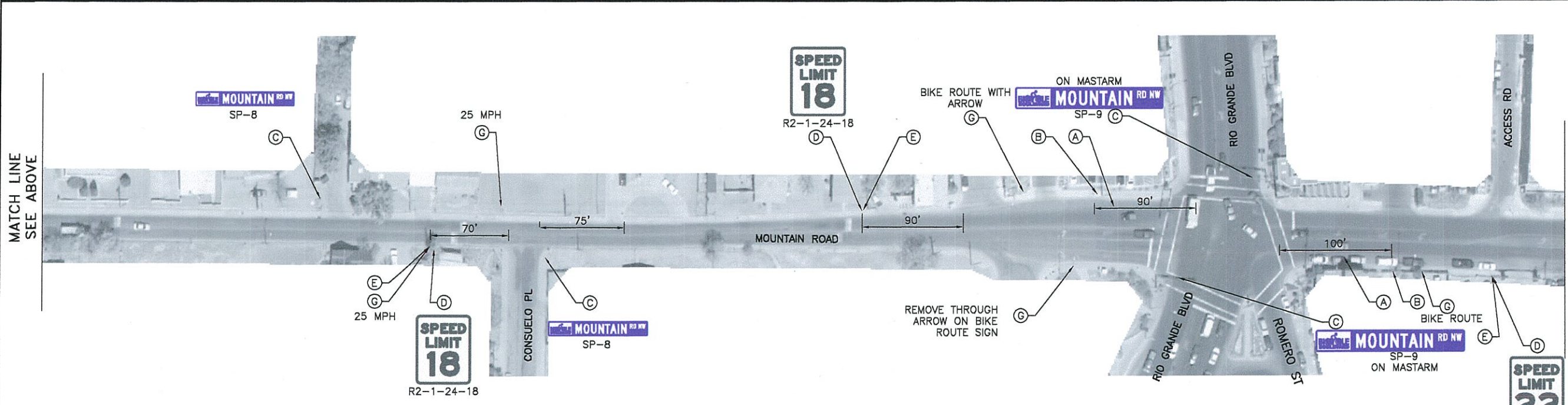
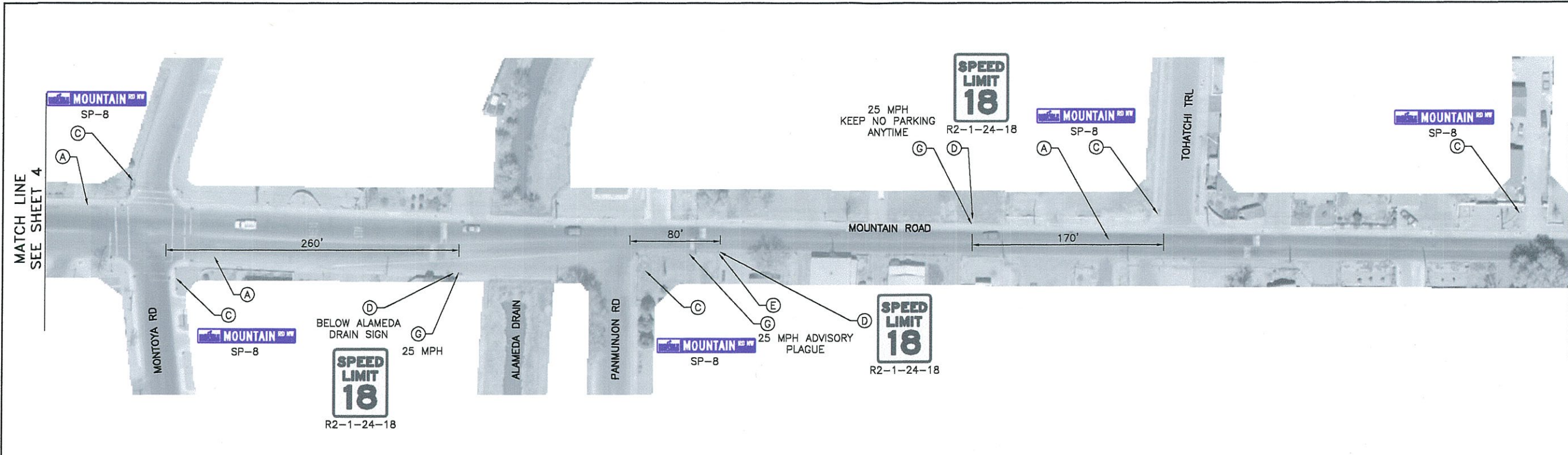

- KEYED NOTES:**
- (A) BICYCLE BOULEVARD PAVEMENT MARKING
  - (B) BICYCLE BOULEVARD SIGN (SP-3)
  - (C) BICYCLE BOULEVARD STREET NAME SIGN
  - (D) SPEED LIMIT SIGN
  - (E) BICYCLE BOULEVARD PLAQUE (SP-4)
  - (F) WAYFINDING SIGN
  - (G) REMOVE CONFLICTING SIGN

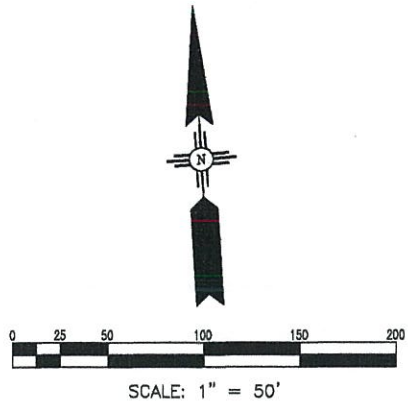

MATCH LINE SEE SHEET 4

MATCH LINE SEE BELOW

AS BUILT INFORMATION	
CONTRACTOR	DATE
WORKED BY	DATE
INSPECTED BY	DATE
ACCEPTANCE BY	DATE
REVISION BY	DATE
DRAWINGS CORRECTED BY	DATE
MICRO-FILM INFORMATION	
RECORDED BY	DATE
NO.	

MATCH LINE SEE ABOVE

MATCH LINE SEE SHEET 6

SURVEY INFORMATION	
FIELD NOTES	DATE
NO.	BY

ENGINEER'S SEAL

11/27/2008

NO.	DATE	REVISIONS	BY
		DESIGN	

DESIGNED BY: MPG DATE: FEB 2008  
 DRAWN BY: MJM DATE: FEB 2008  
 CHECKED BY: DATE: -

**PHASE II**

**Gannett Fleming West, Inc.**  
 2100 Louisiana NE, Suite 8000 Albuquerque, New Mexico 87110  
 Office: (505) 225-8408 Facsimile: (505) 881-2213

**CITY OF ALBUQUERQUE**  
**DEPARTMENT OF MUNICIPAL DEVELOPMENT**

**TITLE: BICYCLE BOULEVARD - MOUNTAIN ROAD, 14TH STREET, SILVER BLVD**  
**BICYCLE BOULEVARD - SIGNING AND STRIPING PLANS**

Design Review Committee	City Engineer Approval	Mo./Day/Yr.	Mo./Day/Yr.

City Project No. 7986-91      Zone Map No. J-12,13,14 K-13,14,15      Sheet 5 OF 22

Mountain Rd - San Felipe to 15th St  
 City Projects - 11/2/2008 1:15 PM - City Printed Date: 11/2/2008  
 San Felipe to 15th St - 11/2/2008 1:15 PM - City Printed Date: 11/2/2008  
 Kathleen A.

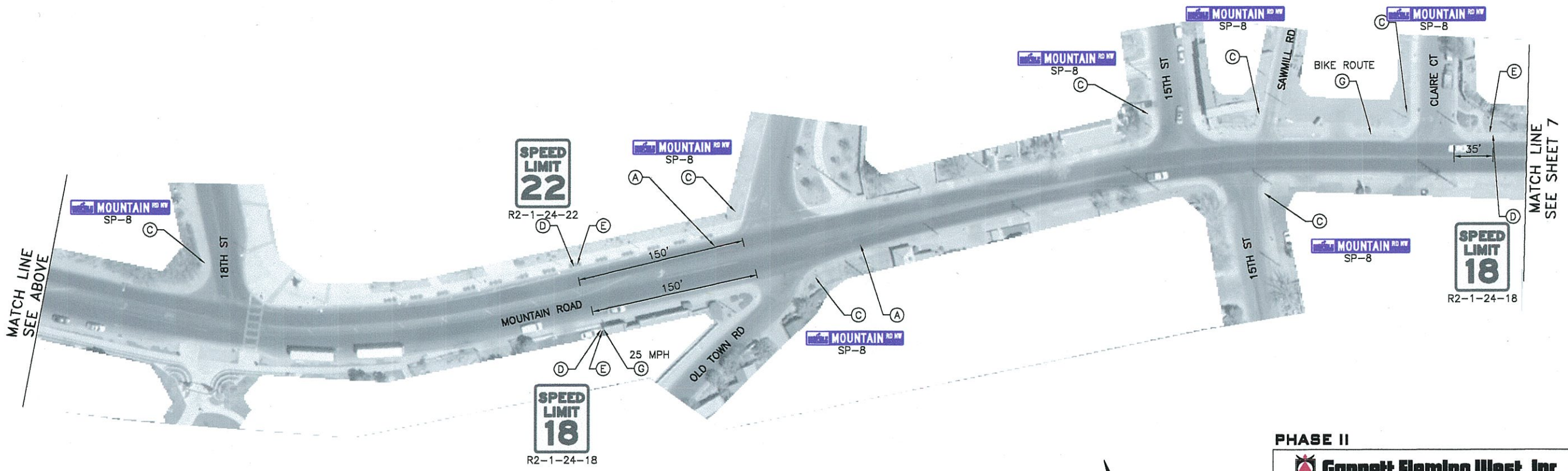
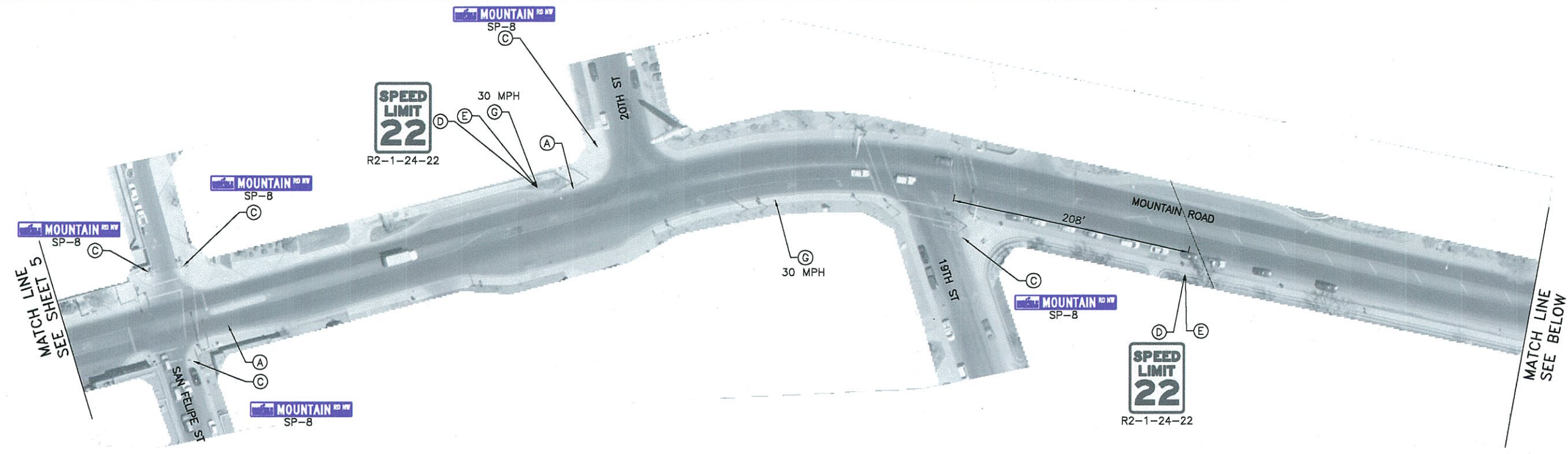

- KEYED NOTES:**
- (A) BICYCLE BOULEVARD PAVEMENT MARKING
  - (B) BICYCLE BOULEVARD SIGN (SP-3)
  - (C) BICYCLE BOULEVARD STREET NAME SIGN
  - (D) SPEED LIMIT SIGN
  - (E) BICYCLE BOULEVARD PLAQUE (SP-4)
  - (F) WAYFINDING SIGN
  - (G) REMOVE CONFLICTING SIGN

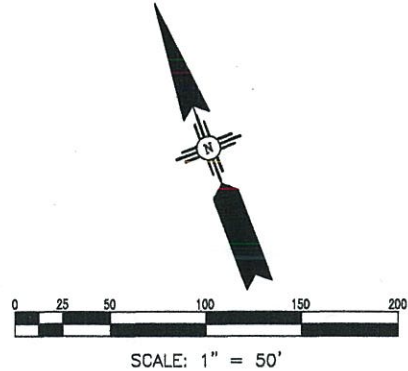

**PHASE II**

**Gannett Fleming West, Inc.**  
 2156 Louisiana NE, Suite 9000 Albuquerque, New Mexico 87110  
 Office: (505) 285-8468 Facsimile: (505) 281-2813



**CITY OF ALBUQUERQUE**  
**DEPARTMENT OF MUNICIPAL DEVELOPMENT**

**TITLE: BICYCLE BOULEVARD - MOUNTAIN ROAD, 14TH STREET, SILVER BLVD**  
**BICYCLE BOULEVARD - SIGNING AND STRIPING PLANS**

Design Review Committee	City Engineer Approval	No./Rev./Yr.	No./Rev./Yr.
City Project No.	Zone Map No.	Sheet	
7986-91	J-12,13,14 K-13,14,15	6 OF 22	

AS BUILT INFORMATION	
CONTRACTOR	DATE
WORK	DATE
INSPECTORS	DATE
ACCEPTANCE BY	DATE
FIELD	DATE
DRAWINGS	DATE
CORRECTED BY	DATE
MICRO-FILM INFORMATION	DATE
RECORDED BY	DATE
NO.	NO.

ENGINEER'S SEAL

11-2-2008

NO.	DATE	REVISIONS	BY
		DESIGN	
DESIGNED BY:	MPG	DATE: FEB 2008	
DRAWN BY:	MJM	DATE: FEB 2008	
CHECKED BY:		DATE: -	

14th St - Mountain Rd to Marquette Ave  
 K:\PROJECTS\48980\Drawings\Boulevard\CADD\PLANS\PLANS West of L-25.dwg  
 Last Saved By: 11/27/2008 1:15 PM -Arcy | Printed Date: 11/27/08 -Rcy, Kathleen A.

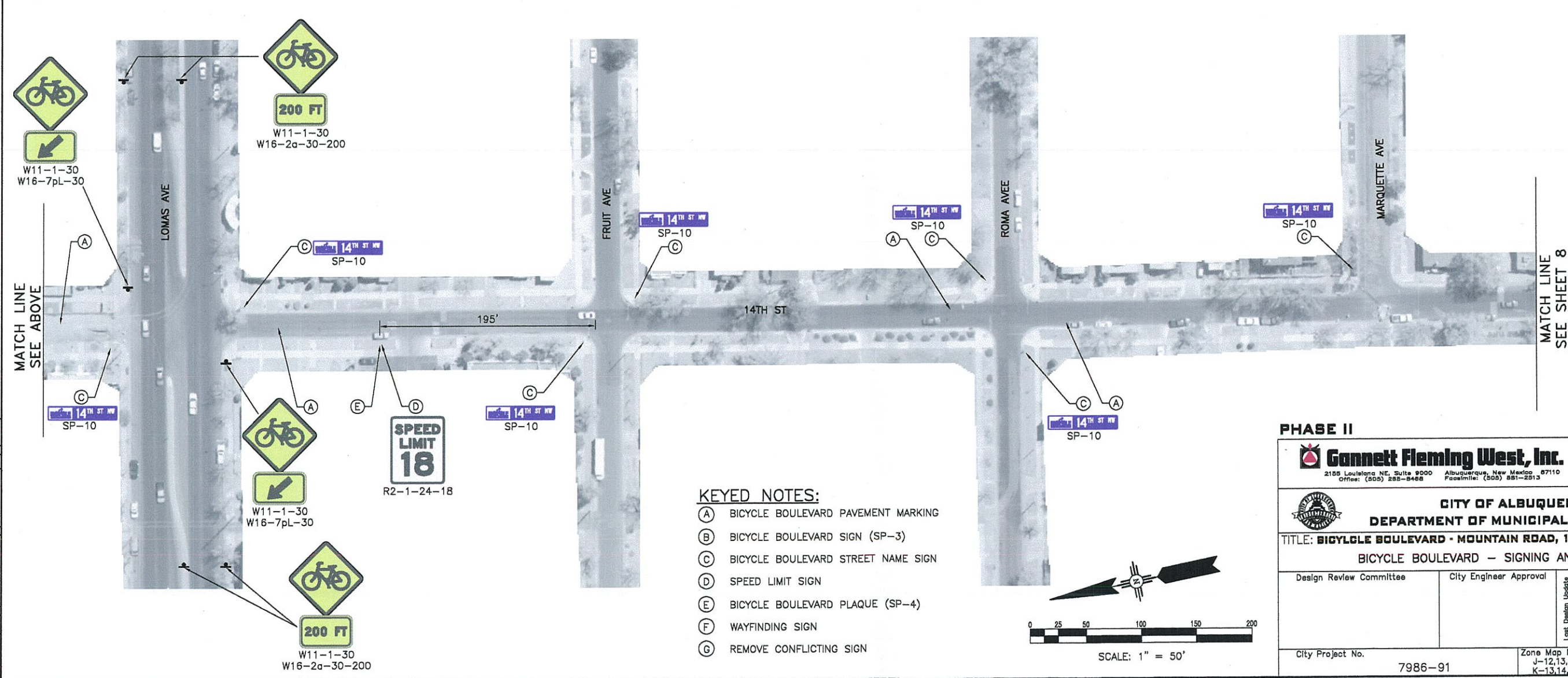
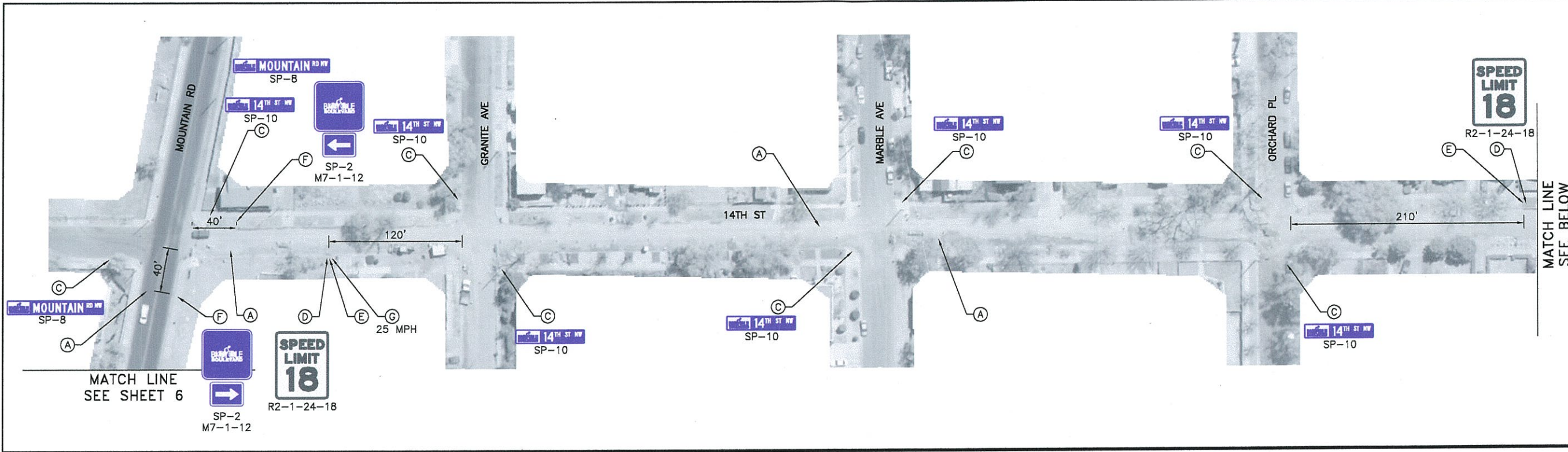

- KEYED NOTES:**
- (A) BICYCLE BOULEVARD PAVEMENT MARKING
  - (B) BICYCLE BOULEVARD SIGN (SP-3)
  - (C) BICYCLE BOULEVARD STREET NAME SIGN
  - (D) SPEED LIMIT SIGN
  - (E) BICYCLE BOULEVARD PLAQUE (SP-4)
  - (F) WAYFINDING SIGN
  - (G) REMOVE CONFLICTING SIGN

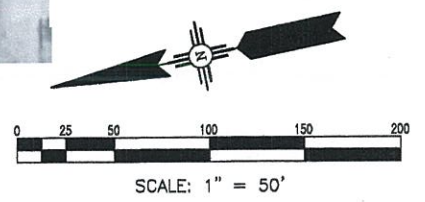

**MATCH LINE SEE BELOW**

AS-BUILT INFORMATION	
CONTRACTOR	DATE
STANDARD BY	DATE
INSPECTOR'S	DATE
ACCEPTANCE BY	DATE
VEGETATION BY	DATE
DRAWINGS	DATE
CORRECTED BY	DATE
MICRO-FILM INFORMATION	
RECORDED BY	DATE
NO.	

**MATCH LINE SEE ABOVE**

SURVEY INFORMATION	
FIELD NOTES	DATE
NO.	
BY	

**ENGINEER'S SEAL**

11/27/2008

NO.	DATE	REMARKS	BY
		DESIGN	

DESIGNED BY: MFG DATE: FEB 2008  
 DRAWN BY: MAM DATE: FEB 2008  
 CHECKED BY: DATE: -

**PHASE II**

**Gannett Fleming West, Inc.**  
 2155 Louisiana NE, Suite 9000 Albuquerque, New Mexico 87110  
 Office: (505) 293-8488 Facsimile: (505) 291-2513

**CITY OF ALBUQUERQUE**  
**DEPARTMENT OF MUNICIPAL DEVELOPMENT**

**TITLE: BICYCLE BOULEVARD - MOUNTAIN ROAD, 14TH STREET, SILVER BLVD**  
**BICYCLE BOULEVARD - SIGNING AND STRIPING PLANS**

Design Review Committee City Engineer Approval

City Project No. 7986-91 Zone Map No. J-12,13,14 K-13,14,15 Sheet 7 OF 22



Silver Ave - 14th to 7th Bicycling Club Plans, West of 10th St. City of Albuquerque, NM. Prepared by: M. J. M. / 1/17/2008. Checked by: M. J. M. / 1/17/2008. Printed by: M. J. M. / 1/17/2008. Kathleen A.

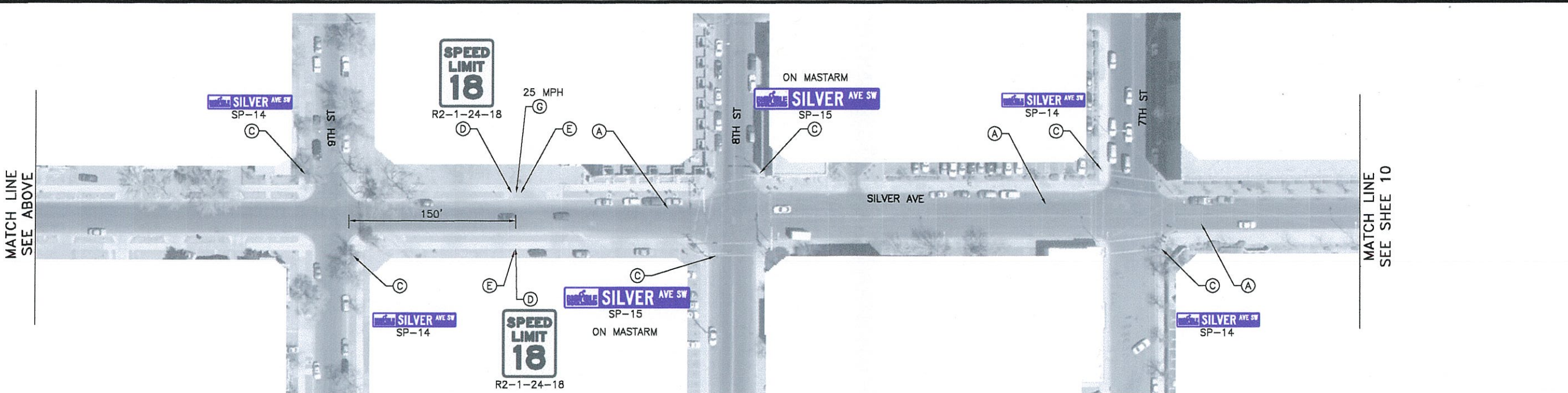
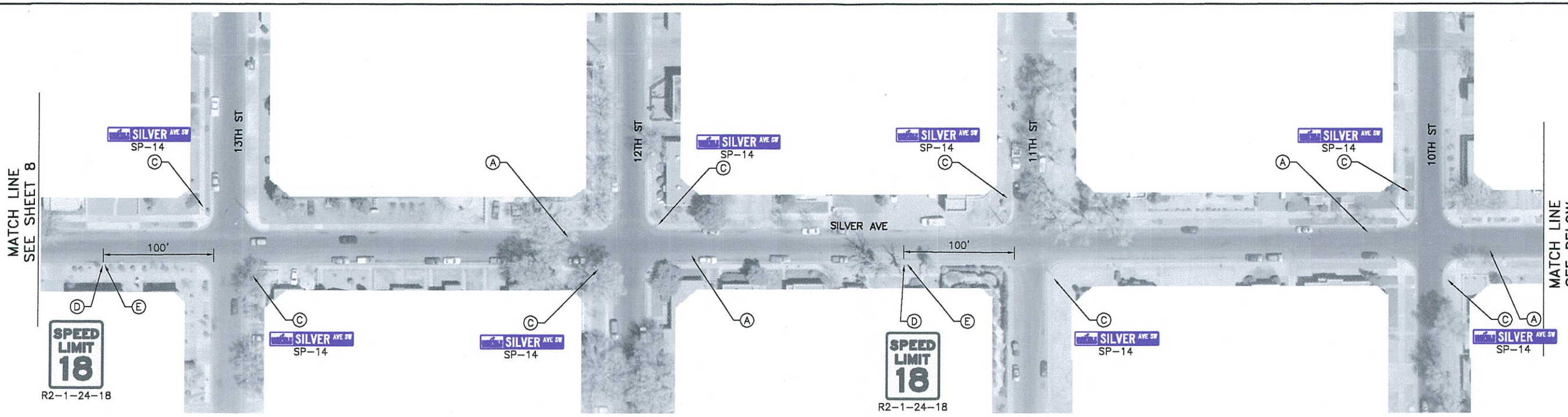

**KEYED NOTES:**

- (A) BICYCLE BOULEVARD PAVEMENT MARKING
- (B) BICYCLE BOULEVARD SIGN (SP-3)
- (C) BICYCLE BOULEVARD STREET NAME SIGN
- (D) SPEED LIMIT SIGN
- (E) BICYCLE BOULEVARD PLAQUE (SP-4)
- (F) WAYFINDING SIGN
- (G) REMOVE CONFLICTING SIGN

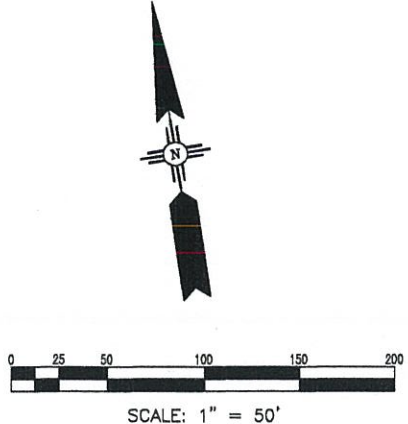

**PHASE II**

**Gannett Fleming West, Inc.**  
 2155 Louisiana NE, Suite 9000 Albuquerque, New Mexico 87110  
 Office: (505) 265-8488 Facsimile: (505) 851-2513

**CITY OF ALBUQUERQUE**  
**DEPARTMENT OF MUNICIPAL DEVELOPMENT**

TITLE: **BICYCLE BOULEVARD - MOUNTAIN ROAD, 14TH STREET, SILVER BLVD**  
**BICYCLE BOULEVARD - SIGNING AND STRIPING PLANS**

Design Review Committee	City Engineer Approval	Ms./Dsr./Yr.	Ms./Dsr./Yr.

City Project No. 7986-91      Zone Map No. J-12,13,14 K-13,14,15      Sheet 9 OF 22

AS BUILT INFORMATION		CONTRACTOR		DATE	
CONTRACTOR	DATE	CONTRACTOR	DATE	CONTRACTOR	DATE
WORK	DATE	WORK	DATE	WORK	DATE
INSPECTOR'S	DATE	INSPECTOR'S	DATE	INSPECTOR'S	DATE
ACCEPTANCE BY	DATE	ACCEPTANCE BY	DATE	ACCEPTANCE BY	DATE
VERIFICATION BY	DATE	VERIFICATION BY	DATE	VERIFICATION BY	DATE
DRAWINGS	DATE	DRAWINGS	DATE	DRAWINGS	DATE
CORRECTED BY	DATE	CORRECTED BY	DATE	CORRECTED BY	DATE
MICRO-FILM INFORMATION		MICRO-FILM INFORMATION		MICRO-FILM INFORMATION	
RECORDED BY	DATE	RECORDED BY	DATE	RECORDED BY	DATE
NO.	DATE	NO.	DATE	NO.	DATE

ENGINEER'S SEAL  
 11-7-2008  
 MATTIE P. GRUBB  
 PROFESSIONAL ENGINEER  
 NEW MEXICO  
 19906

NO.	DATE	REVISIONS	BY
		DESIGN	

DESIGNED BY:	DATE:	DESIGNED BY:	DATE:
MPG	FEB 2008	MPG	FEB 2008
MJM	FEB 2008	MJM	FEB 2008













Bryn Mawr to Solano  
 K. PROJECTIONS, INC., 1125 17th St. SW, Albuquerque, NM 87102  
 Date: 11/2/2008 11:25 AM - 11:25 AM  
 11/2/2008 11:25 AM - 11:25 AM  
 K. PROJECTIONS, INC.

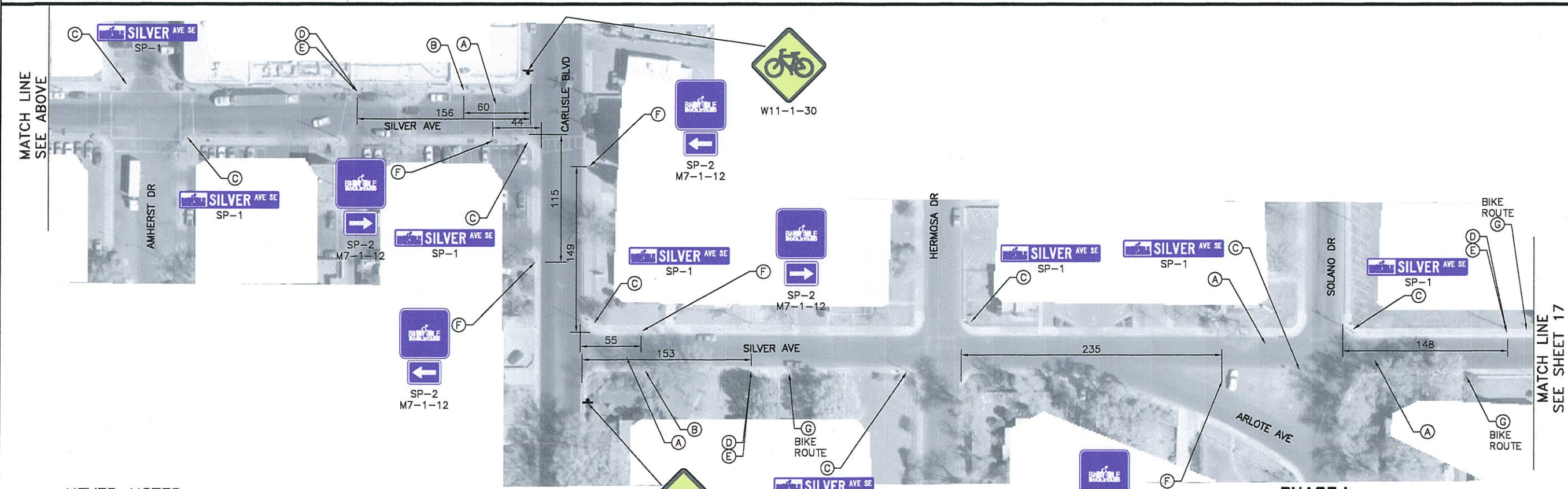
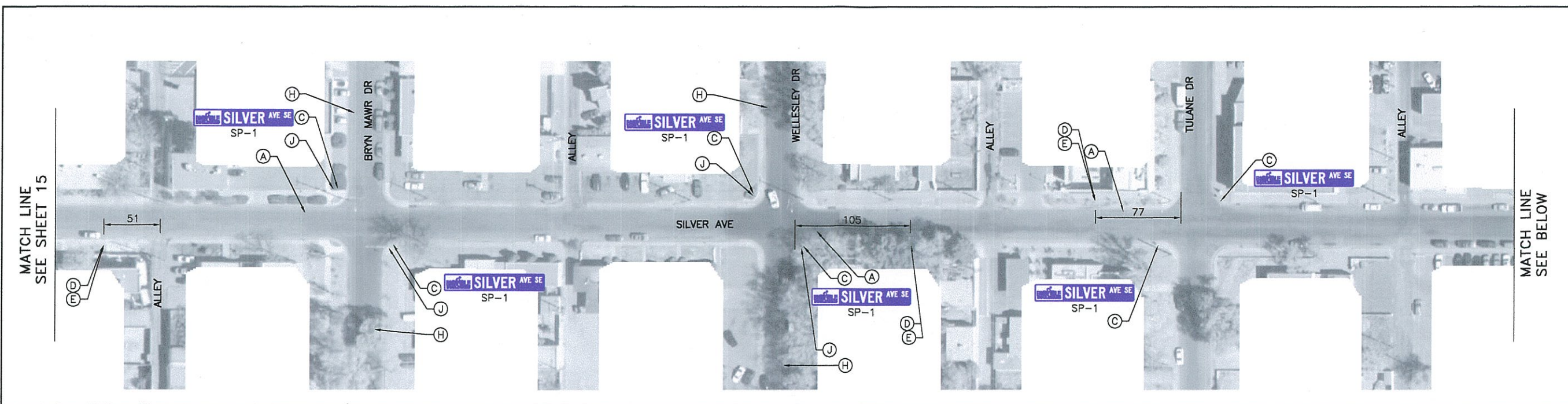

- KEYED NOTES:**
- (A) BICYCLE BOULEVARD PAVEMENT MARKING
  - (B) BICYCLE BOULEVARD SIGN (SP-3)
  - (C) BICYCLE BOULEVARD STREET NAME SIGN
  - (D) SPEED LIMIT SIGN
  - (E) BICYCLE BOULEVARD PLAQUE (SP-4)
  - (F) WAYFINDING SIGN
  - (G) REMOVE CONFLICTING SIGN
  - (H) STOP AHEAD PAVEMENT MARKING, STOP AHEAD SIGN W3-1-36 TO BE PLACED 150 FEET IN ADVANCE OF STOP BAR
  - (J) STOP SIGN REPLACE WITH R1-1-36

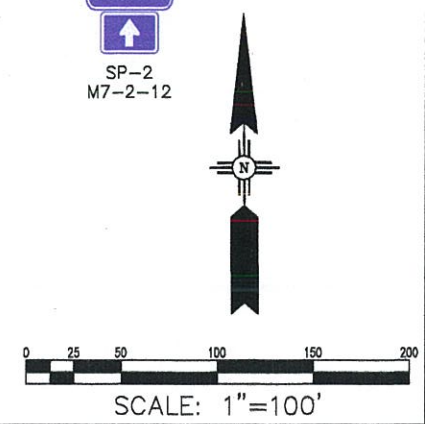

**PHASE I**

**Gannett Fleming West, Inc.**  
 2155 Louisiana NE, Suite 9000 Albuquerque, New Mexico 87110  
 Office: (505) 283-8488 Fax: (505) 881-2513

**CITY OF ALBUQUERQUE**  
**DEPARTMENT OF MUNICIPAL DEVELOPMENT**

TITLE: **BICYCLE BOULEVARD - MOUNTAIN ROAD, 14TH STREET, SILVER BLVD**  
**BICYCLE BOULEVARD - SIGNING AND STRIPING PLANS**

Design Review Committee	City Engineer Approval	No./By/Tr.	No./By/Tr.

City Project No. 7986-91      Zone Map No. K-15 TO 17      Sheet 16 OF 22

AS BUILT INFORMATION	
CONTRACTOR	DATE
WORK	DATE
INSPECTED BY	DATE
ACCEPTANCE BY	DATE
FIELD FUNCTION BY	DATE
DRAWINGS	DATE
CORRECTED BY	DATE
MICRO-FILM INFORMATION	
RECORDED BY	DATE
NO.	

SURVEY INFORMATION	
FIELD NOTES	BY DATE
NO.	

ENGINEER'S SEAL

11/2/2008

NO.	DATE	REVISIONS	BY
		DESIGN	

DESIGNED BY: MPG      DATE: MAY 2008  
 DRAWN BY: BRS      DATE: MAY 2008  
 CHECKED BY: CG      DATE: MAY 2008

BENCH MARKS	

MATCH LINE  
SEE BELOW

MATCH LINE  
SEE SHEET 17

MATCH LINE  
SEE SHEET 15

MATCH LINE  
SEE ABOVE











